

For full product information, visit www.sti.com. Use the SpeedSPEC Code for quick access to the specific web page.

Safety Light Curtains

- Fast and easy installation
- Resolution: 25 mm (1.01 in.)
- Range: 7 m (23 ft.)
- Protected heights: 185 to 1105 mm (7.28 to 43.50 in.)
- Very compact size: 30 x 30 mm (1.18 x 1.18 in.)
- Cross-talk prevention
- 3 m integrated cables
- A Rapid Delivery Product: Select models are available for shipment today or within 3 to 5 days

D



Description

The EASY type safety light curtain is well suited for straight-forward on/off detection applications.

By carefully selecting the available functions, we have reduced man hours necessary for installation by approximately 1/2 when compared with existing STI models.

Reduced installation time means added savings to your project's budget, start with the EASY type.

Machine safety first, narrowed down to the simplest functions:

Upon detection of personnel, the machine stops. Simple yet very optimal.

I only need simple functions



1/2 the mounting time. Fixed response time makes calculation of the safety distance easier.

Reduced wiring, quick mount brackets and easy-to-view alignment beams all add up to cost savings. Additionally, with one fixed response time, it is now easier to calculate the safety distance.



1/2 Mounting Time

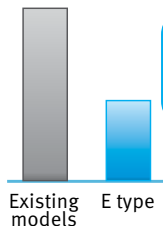

Existing models E type

Global Support

Omron will support you through our global network.



Global Support

Easy-to-view Diagnostics

These indicators enable you to intuitively know the status and cause of any error. This allows faster installation while reducing machine down time.



Easy-to-View Diagnostics

Select models are available for Rapid Delivery.

Visit this product on www.sti.com for details.

Specifications

Main Units

F3SJ-E□□□□P25

| | | |
|---|---|--|
| Sensor type | Type 4 safety light curtain | |
| Setting tool connection *1 | Parameter settings: Not available | |
| Safety category | Safety purpose of category 4, 3, 2, 1, or B | |
| Detection capability | Opaque objects 25 mm in diameter | |
| Beam gap (P) | 20 mm | |
| Number of beams (n) | 8 to 54 | |
| Protective height (PH) | 185 to 1,105 mm | |
| Lens diameter | Diameter 5 mm | |
| Operating range *2 | 0.2 to 7 m | |
| Response time (under stable light incident condition) | ON to OFF | 15 ms max. |
| | OFF to ON | 70 ms max. |
| Startup waiting time | 2 s max. | |
| Power supply voltage (Vs) | SELV/PELV 24 VDC±20% (ripple p-p 10% max.) | |
| Consumption current (no load) | Emitter | Up to 22 beams: 41 mA max., 26 to 42 beams: 57 mA max., 46 to 54 beams: 63 mA max. |
| | Receiver | Up to 22 beams: 42 mA max., 26 to 42 beams: 47 mA max., 46 to 54 beams: 51 mA max. |
| Light source (emitted wavelength) | Infrared LED (870 nm) | |
| Effective aperture angle (EAA) | Based on IEC 61496-2. Within ±2.5° for both emitter and receiver when the detection distance is 3 m or over | |
| Safety outputs (OSSD) | Two PNP transistor outputs, load current 200 mA max., residual voltage 2 V max. (except for voltage drop due to cable extension), Leakage current 1 mA max., load inductance 2.2 H max. *3 Maximum capacity load 1 µF *4 | |
| Output operation mode | Safety output: On when receiving light | |
| Input voltage | ON voltage: Vs-3 V to Vs *5 OFF voltage: 0 V to 1/2 Vs or open | |
| Mutual interference prevention function | Mutual interference prevention algorithm prevents interference in up to 3 sets. | |
| Test function | Self test (at power-ON and at power distribution) External test (emission stop function by test input) | |
| Protection circuit | Output short-circuit protection, and power supply reverse polarity protection | |
| Ambient temperature | Operating: -10 to 55°C (non-freezing), Storage: -25 to 70°C | |
| Ambient humidity | Operating: 35% to 85% (no condensation), Storage: 35% to 95% RH | |
| Operating ambient light intensity | Incandescent lamp: 3,000 lx max., Sunlight: 10,000 lx max. | |
| Insulation resistance | 20 MΩ min. (at 500 VDC) | |
| Dielectric strength | 1,000 VAC 50/60 Hz, 1 min | |
| Degree of protection | IP65 (IEC 60529) | |
| Vibration resistance | Malfunction: 10 to 55 Hz, Multiple amplitude of 0.7 mm, 20 sweeps in X, Y, and Z directions | |
| Shock resistance | Malfunction: 100 m/s ² , 1,000 times each in X, Y, and Z directions | |
| Pollution degree | Pollution degree 3 (IEC 60664-1) | |
| Power cable | Connection method: Pull-out type, cable length 3 m Number of wires: Emitter: 5 wires, receiver: 6 wires Cable diameter: Dia. 6 mm Allowable bending radius: R5 mm | |
| Extension cable | 30 m max. *6 | |
| Material | Case: Aluminum Cap: ABS resin, PBT Optical cover: PMMA resin (acrylic) Cable: Oil resistant PVC | |
| Weight (packed state) | Weight (g) = (protective height) x 2.6 + 800 | |
| Accessories | Test rod, User's Manual (CD-ROM) *7 | |
| Applicable standards | IEC 61496-1, EN 61496-1 UL 61496-1, Type 4 ESPE (Electro-Sensitive Protective Equipment) IEC 61496-2, CLC/TS 61496-2, UL 61496-2, Type 4 AOPD (Active Opto-electronic Protective Devices) IEC 61508-1 to -3, EN 61508-1 to -3 SIL3 IEC 13849-1: 2006, EN ISO 13849-1: 2008 (PL _e , Cat.4) UL 508, UL 1998, CAN/CSA C22.2 No.14, CAN/CSA C22.2 No.0.8 | |

*1. Do not use the Support Software and Setting Console for F3SJ-A.
Operation cannot be guaranteed.

*2. Use of the Spatter Protection Cover causes a 10% maximum sensing distance attenuation.

*3. The load inductance is the maximum value when the safety output frequently repeats ON and OFF. When you use the safety output at 4 Hz or less, the usable load inductance becomes larger.

*4. These values must be taken into consideration when connecting elements including a capacitive load such as capacitor.

*5. The Vs indicates a voltage value in your environment.

*6. To extend a cable of the F3SJ-E, refer to "Chapter 3 Wiring (Extension Cable)" in the User's Manual.

*7. Mounting brackets are sold separately.

Wiring

Basic Wiring Diagram

Wiring when using a test input line

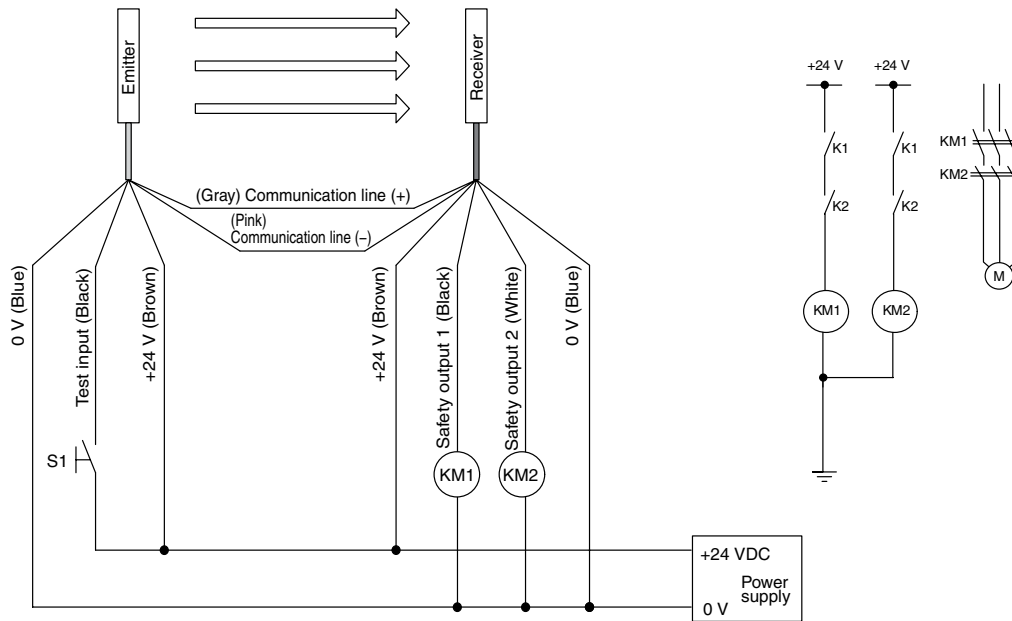

- S1 : External test/lockout reset switch (connect to 0 V if a switch is not required)
 KM1, KM2 : Safety relay with force-guided contact (G7SA) or magnetic contactor

 Select models are available for Rapid Delivery.

Visit this product on www.sti.com for details.

Dimensions (continued)

(mm)

Main Units

When Using Quick Mount Brackets

Backside mounting

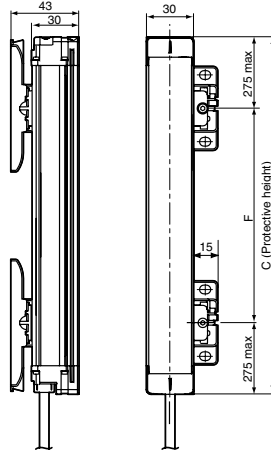
Quick Mount Bracket
(F39-LJB3-M6 or
F39-LJB3-M8)Quick Mount Bracket
(F39-LJB3-M6 or
F39-LJB3-M8)

Mounting screw holes

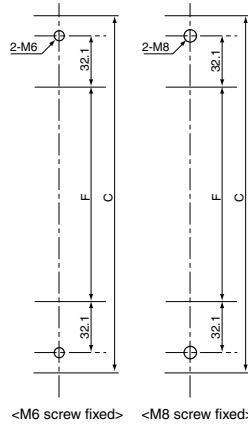
C (protective height): 4-digit number in the table
F = See the table below.

| Protective height | Number of intermediate brackets | F |
|-------------------|---------------------------------|-------------|
| 185 to 1,105 | 2 | 555 mm max. |
| 1,185 to 1,585 | 3 | 555 mm max. |
| 1,665 to 2,065 | 4 | 555 mm max. |

Side mounting

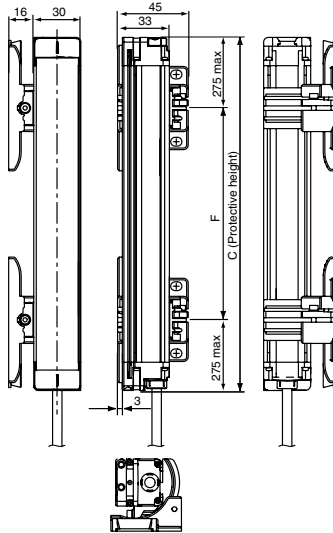
Quick Mount Bracket
(F39-LJB3-M6 or
F39-LJB3-M8)Quick Mount Bracket
(F39-LJB3-M6 or
F39-LJB3-M8)

Mounting screw holes

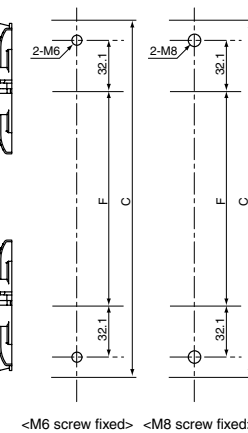
C (protective height): 4-digit number in the table
F = See the table below.

| Protective height | Number of intermediate brackets | F |
|-------------------|---------------------------------|-------------|
| 185 to 1,105 | 2 | 555 mm max. |
| 1,185 to 1,585 | 3 | 555 mm max. |
| 1,665 to 2,065 | 4 | 555 mm max. |

Dimensions of quick mount bracket for F39-LJB3

Backside mounting

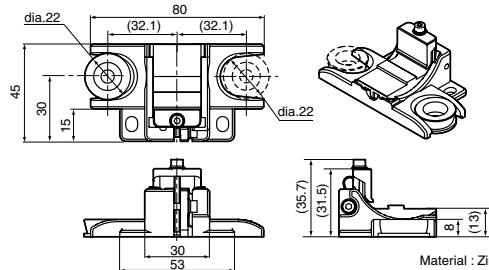

Material : Zinc die-cast

Quick mount M6 bracket

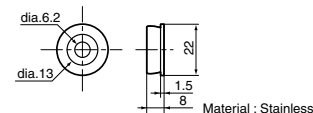

Quick mount M8 bracket

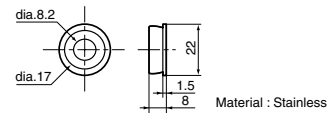

Side mounting

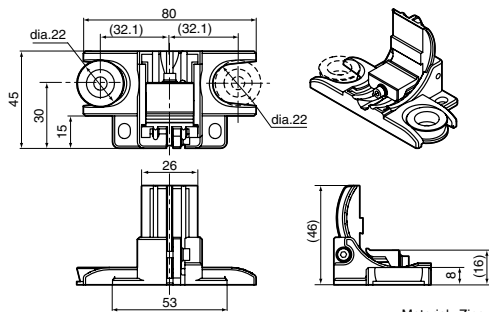

Material : Zinc die-cast

Ordering

Main Units

Safety Light Curtains

| Application | Detection capability | Beam gap | Operating range | Protective height (mm) | Model |
|-----------------|----------------------|----------|-----------------|------------------------|---------------|
| | | | | | PNP output |
| Hand protection | Dia. 25 mm | 20 mm | 0.2 to 7 m | 185 to 1,105 | F3SJ-E□□□□P25 |

Safety Light Curtain Model List

Please contact our sales representatives.





F3SJ-E Series (20 mm pitch)

| Model | Number of beams | Protective height [mm] * | Model | Number of beams | Protective height [mm] * |
|---------------|-----------------|--------------------------|---------------|-----------------|--------------------------|
| F3SJ-E0185P25 | 8 | 185 | F3SJ-E0705P25 | 34 | 705 |
| F3SJ-E0225P25 | 10 | 225 | F3SJ-E0785P25 | 38 | 785 |
| F3SJ-E0305P25 | 14 | 305 | F3SJ-E0865P25 | 42 | 865 |
| F3SJ-E0385P25 | 18 | 385 | F3SJ-E0945P25 | 46 | 945 |
| F3SJ-E0465P25 | 22 | 465 | F3SJ-E1025P25 | 50 | 1,025 |
| F3SJ-E0545P25 | 26 | 545 | F3SJ-E1105P25 | 54 | 1,105 |
| F3SJ-E0625P25 | 30 | 625 | | | |

*Protective height (mm) = Total sensor length

Accessories (sold separately)

Relays with Forcibly Guided Contacts

| Type | Appearance | Specifications | Model | Remarks |
|--|---|---|------------|---|
| G7SA Relays with Forcibly Guided Contacts |  | <ul style="list-style-type: none"> Nodes: 4 Contact type: 2A2B Rated switch load: 250 VAC 6A, 30 VDC 6A | G7SA-2A2B |  For information on the G7SA see page I-3 or visit www.sti.com . |
| | | <ul style="list-style-type: none"> Nodes: 4 Contact type: 3NO+1NC Rated switch load: 250 VAC 6A, 30 VDC 6A | G7SA-3A1B | |
| G7S-□-E Relays with Forcibly Guided Contacts |  | <ul style="list-style-type: none"> Nodes: 6 Contact type: 4NO+2NC Rated switch load: 250 VAC 10 A, 30 VDC 10 A | G7S-4A2B-E |  For information on the G7S-□-E see page I-9 or visit www.sti.com . |
| | | <ul style="list-style-type: none"> Nodes: 6 Contact type: 3NO+3NC Rated switch load: 250 VAC 10 A, 30 VDC 10 A | G7S-3A3B-E | |

Laser Pointer

| Appearance | Output | Model |
|---|------------------------|---------|
|  | Laser Pointer for F3SJ | F39-PTJ |

(Continued on next page)





 Select models are available for Rapid Delivery.

Visit this product on www.sti.com for details.

Ordering (continued)

Accessories (sold separately) (continued)

Sensor Mounting Bracket (sold separately)

| Appearance | Specifications | Model | Application | Remarks |
|---|-----------------------------|-----------------|---|---|
|  | Top/bottom bracket | F39-LJB1 | Top/bottom bracket for F3SJ-E/B | 2 for the emitter, 2 for the receiver, total of 4 per set |
|  | Intermediate bracket | F39-LJB2 *1 *2 | In combination use with top/bottom bracket for F3SJ-E/B Can be used as free-location bracket. | 1 set with 2 pieces |
|  | Quick mount bracket | F39-LJB3-M6 *1 | Quick mount bracket for F3SJ-E/B Supports M6 slide nut for aluminum frame. | 1 set with 2 pieces |
| | | F39-LJB3-M8 *2 | Quick mount bracket for F3SJ-E/B Supports M8 slide nut for aluminum frame. | |
|  | M6 slide nut | F39-LJB3-M6K *1 | Spare slide nut for use with Quick mount bracket. | Hexagon socket head cap screws (M6 x 10) are included. |
| | M8 slide nut | F39-LJB3-M8K *2 | | Hexagon socket head cap screws (M8 x 14) are included. |
|  | Compatible mounting bracket | F39-LJB4 | Mounting bracket used when replacing existing area sensors (F3SJ-A or F3SN) with the F3SJ-E/B. | 2 for the emitter, 2 for the receiver, total of 4 per set |

Note: All the sensor mounting brackets for the F3SJ-E are sold separately.

*1. Combining F39-LJB2 and F39-LJB3-M6K makes F39-LJB3-M6.

*2. Combining F39-LJB2 and F39-LJB3-M8K makes F39-LJB3-M8.



For information on Resource
Modules, see page D-63.



For information on safety light
curtain accessories, see page D-78.



Select models are available for Rapid Delivery.

Visit this product on www.sti.com for details.