



- State-of-the-art LED technology with high luminous efficacy and long service life
- Extremely high luminaire efficacy
- Luminous flux after 100,000 h still 90% of the starting luminous flux
- Optionally with DALI for controlling and monitoring the luminaire
- Optionally with address modules for directly actuation of a common battery system

E2

WebCode 6402C



The linear luminaire with Series 6402/4 LED is ideal for lighting surfaces at a mounting height of up to 10 m. It can also be used to illuminate equipment and objects, both inside and outside. The pole mounting sleeve accessory can be used to easily mount the luminaire on poles. Optionally, the luminaire can be equipped with an address module. It can be used to control and monitor the luminaire for the common battery systems.

	ATEX / IECEx					
Zone	0	1	2	20	21	22
Installation in			•		•	•





Selection Table						
Design size	2					
Lamp wattage	22 W					
Luminous flux	Luminaire efficacy	Product variant	Product Type	Art. No.	PS	Weight kg
2910 lm	132 lm/W	without address module	6402/4128-6100-152-1110-11-8500	267040	64	3.200
		with address module	6402/4128-6120-152-1110-11-8500	267039	64	3.300
Design size	4					
Lamp wattage	42 W					
Luminous flux	Luminaire efficacy	Product variant	Product Type	Art. No.	PS	Weight kg
5810 lm	138 lm/W	without address module	6402/4148-6100-152-1110-11-8500	267054	64	5.600
		with address module	6402/4148-6120-152-1110-11-8500	267057	64	5.600

Screw connections and stopping plugs made from moulded material are included loose with the product (installation required).
Threaded plate included.

The light fittings are supplied without mounting material.

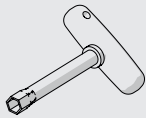
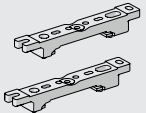
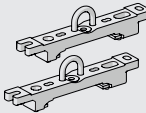
Technical Data		
Variant	without address module	with address module
Explosion Protection		
Gas explosion protection IECEx	Ex ec IIC T4 Gc	Ex ec nC IIC T4 Gc
Gas explosion protection ATEX	⊕ II 3 G Ex ec IIC T4 Gc	⊕ II 3 G Ex ec nC IIC T4 Gc
Dust explosion protection IECEx	Ex tb op is IIIC T100 °C Db	Ex tb op is IIIC T100 °C Db
Dust explosion protection IECEx 2	Ex tc IIIC T100 °C Db	Ex tc IIIC T100 °C Db

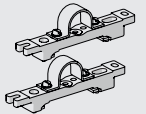
Technical Data		
Variant	without address module	with address module
Explosion Protection		
Dust explosion protection ATEX	⊕ II 2 D Ex tb op is IIIC T100 °C Db	⊕ II 2 D Ex tb op is IIIC T100 °C Db
Dust Explosion Protection ATEX 2	⊕ II 2 D Ex tc IIIC T100 °C Db	⊕ II 2 D Ex tc IIIC T100 °C Db
Ambient temperature °C	-40 ... +55 °C	-30 ... +45 °C
Note: Through wiring	Max. 3x16 A	Max. 3x16 A
Ambient temperature °C 2	-40 ... +60 °C	-30 ... +50 °C
Note: Through wiring 2	Max. 3x10 A	Max. 3x10 A
Certificates	ATEX (IBE), IECEx (IBE), India (PESO)	ATEX (IBE), IECEx (IBE), India (PESO)
Electrical Data		
Rated operational voltage AC	220 – 240 V	220 – 230 V
Frequency range	50 – 60 Hz	50 – 60 Hz
Rated operational voltage DC	200 – 250 V	200 – 250 V
Lighting Data		
Number of lamps	1	1
Lamp	LED	LED
Light colour	Neutral white	Neutral white
Light distribution	120°x120° with diffusing glass	120°x120° with diffusing glass
Colour rendering	≥ 80	≥ 80
Colour temperature	5000 K	5000 K
Mechanical Data		
Impact strength (IK code)	IK10 (IEC 62262)	IK10 (IEC 62262)
Degree of protection IP (IEC 60598)	IP66/IP67	IP66/IP67
Enclosure colour	Light grey (RAL 7035)	Light grey (RAL 7035)
Enclosure material	Polyester resin, Glass fibre reinforced	Polyester resin, Glass fibre reinforced
Diffuser	With diffuser	With diffuser
Sealing material	Silicone	Silicone
Installed terminal strip	PE + N + L1 + L2 + L3	PE + N- + L+ + N' + L'
Connection terminals solid max.	6 mm ²	6 mm ²
Connection terminals finely-stranded max.	4 mm ²	4 mm ²
Type of connection cable	Finely stranded Solid	Finely stranded Solid
Notes	Connection terminals: Spring clamp terminal (2 free clamping units per pole)	
Components		
Threaded plate	2x plastic	2x plastic
Address module		UNI Modul ADR 20-ILS-Z2
Ballast	VG Luxtronic 80 W 300 mA	VG Luxtronic 80 W 300 mA
Through wiring	With 5 conductors 2.5 mm ²	With 5 conductors 2.5 mm ²
Drilled holes	3 x M25	3 x M25
Screw connections	2 x M25 Ø 7 – 17 mm	2 x M25 Ø 7 – 17 mm
Material of screw connections	Polyamide, black	Polyamide, black
Stopping plug	2 x M25 x 1.5	2 x M25 x 1.5
Stopping plug material	Polyamide, black	Polyamide, black

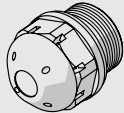
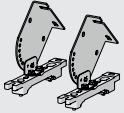
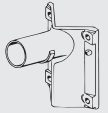
Accessories and Spare Parts			
Figure	Description	Art. No.	Weight kg
Socket key			
	M8 / wrench size 13; to open/close the central locking	222430 ▲	0.210
Mounting rail			
	for a variable mounting distance; 1 pair	222826 ▲	0.350
Mounting bracket			
	mounting clamp mounted on a mounting rail for a variable mounting distance; 1 pair	222456 ▲	0.400
Pole mounting sleeve			
	for the subsequent mounting on lights size 2 and size 4, completely with assembly parts	227512	3.200
Pipe clamp			
	R 1 1/2"; with mounting rail for a variable mounting distance; Material: stainless steel; 1 pair	222459 ▲	1.200
	R 1 1/4"; with mounting rail for a variable mounting distance; Material: stainless steel; 1 pair	222458 ▲	0.700
	R 2"; with mounting rail for a variable mounting distance; Material: stainless steel; 1 pair	222460 ▲	0.750
Ring bolt			
	M8, direct mounting in insert nuts; 1 pair	115736 ▲	0.115
Breather			
	Thread: M25 x 1.5; 1 pc; for installation in lights; in moulded material; without counter nut	138573 ▲	0.010
	Thread: M25 x 1.5; 20 pc; for installation in lights; in moulded material; without counter nut	138576 ▲	0.200
Ceiling and wall mounting bracket			
	mounted on a mounting rail for a variable mounting distance; Material: stainless steel; Lamp can be swiveled in steps of 15°; 1 pair	222827 ▲	1.200
Bracket for wall mounting with tube			
	for side entry lamp; with tube, length 400 mm, Ø 42 mm	108947 ▲	2.480

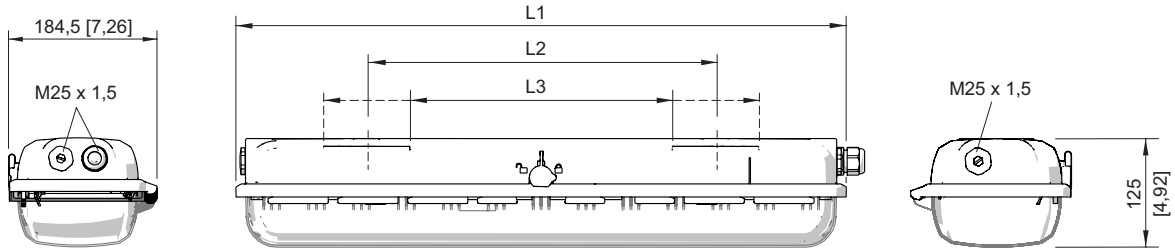

Size 2:
L1 = 700 mm [27.56]
L2 = 400 mm [15.75]
L3 = 320 ... 480 mm [12.60 ... 18.90]

Size 4:
L1 = 1310 mm [51.57]
L2 = 800 mm [31.50]
L3 = 670 ... 930 mm [26.38 ... 36.61]

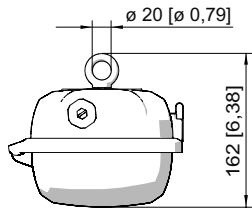

Ring bolt fitted in insert nut of the luminaire

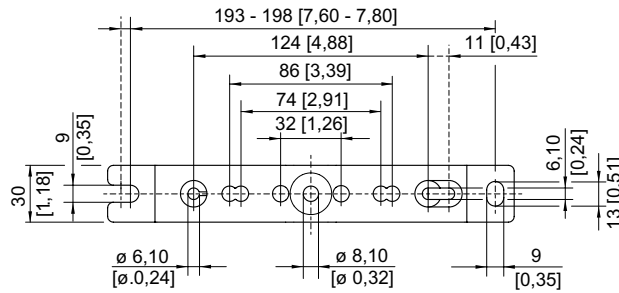
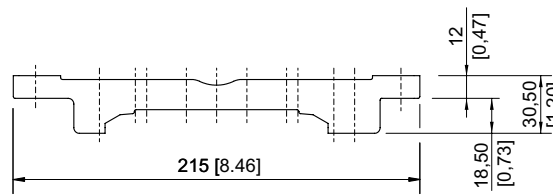

Mounting rail

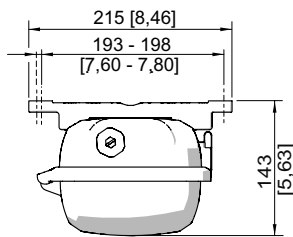

Mounting rail

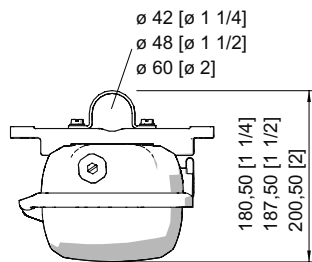

Pipe clamp fitted in mounting rail

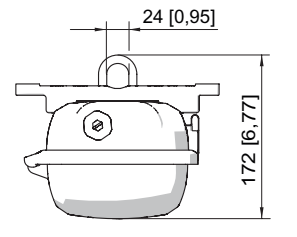

Mounting bracket fitted in mounting rail

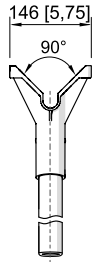
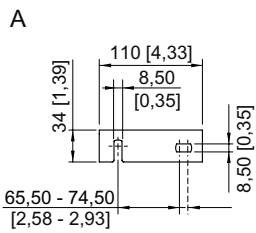
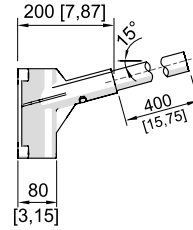
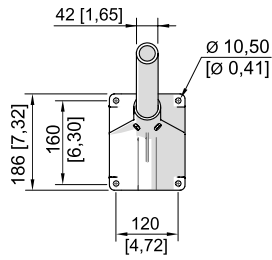
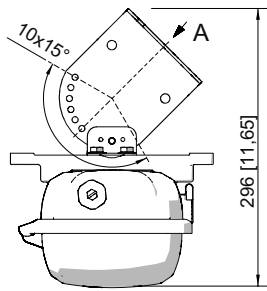

Wall mounting bracket fitted in mounting rail

Bracket for wall mounting with pipe section

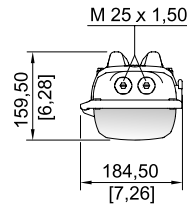
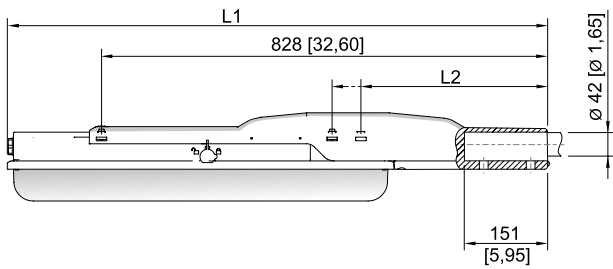

With pole mounting sleeve

Size 2:
L1 = 978 mm [38.50]
L2 = 390 mm [15.35]

Size 4:
L1 = 1587 mm [62.48]
L2 = 338 mm [13.31]