

For full product information, visit www.sti.com. Use the SpeedSPEC Code for quick access to the specific web page.

Super Small Class 6-Contact Guard Lock Safety-Door Switch

D4SL-N Guard Lock Safety-door Switch

- Wiring time is reduced with two types of wiring methods capable of one-touch attachment and removal.
- A wide variety of built-in switches can be used for various devices. (4-, 5-, and 6-contact models are available)
- Key holding force of 1,300 N.
- It is possible to change the key insertion point without detaching the head.
- Drive solenoids directly from the Controller.
- A Rapid Delivery Product: Select models are available for shipment today or within 3 to 5 days.

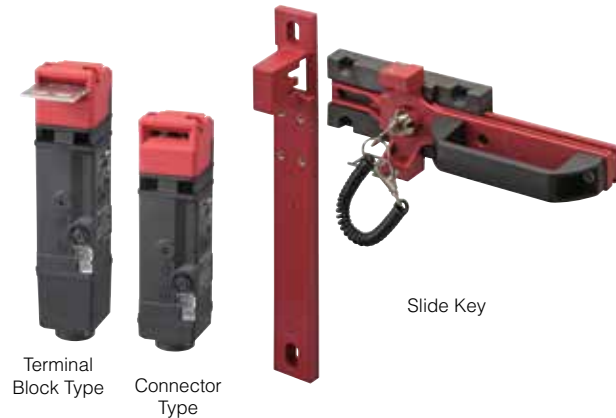

D4SL-NSK10-LK Slide Key

- Lockout Key to prevent workers from becoming trapped inside the hazardous area.
- The vertical D4SL Guard Lock Safety-door Switch can be easily mounted on 40 x 40 mm aluminum frames.
- The plastic material makes the Key suitable for lightweight doors.



G

Specifications

Standards and EC Directives

Conforms to the following EC Directives:

- Machinery Directive
- Low Voltage Directive
- EMC Directive
- EN 1088
- EN 60204-1
- GS-ET-19

Certified Standards

Certification body	Standard	File No.
TÜV SÜD	EN 60947-5-1 (certified direct opening)	Consult your representative for details.
UL *1	UL 508, CSA C22.2 No.14	E76675
CQC (CCC)	GB14048.5	pending
KOSHA *2	EN60947-5-1	

*1.Certification has been obtained for UL CSA C22.2 No. 14.

Certified Standard Ratings

TÜV (EN 60947-5-1)

Utilization category	AC-15	DC-13
Rated operating current (Ie)	1.5 A *1 1 A *2	0.22 A
Rated operating voltage (Ue)	120 V	125 V

Note: Use a 4 A fuse that conforms to IEC 60127 as a short-circuit protection device. This fuse is not included with the switch.

*1. 11-42, 21-42, 21-22

*2. Other terminals

UL/CSA (UL 508, CSA C22.2 No. 14) C150

Rated voltage	Carry current	Current (A)		Volt-amperes (VA)	
		Make	Break	Make	Break
120 VAC	2.5 A	15	1.5	1,800	180

R150

Rated voltage	Carry current	Current (A)		Volt-amperes (VA)	
		Make	Break	Make	Break
125 VDC	1.0 A	0.22	0.22	28	28

Solenoid Coil Characteristics

Item	24 VDC
Rated operating voltage (100% ED)	24 VDC ^{+10%} _{-15%}
Current consumption*	Power ON: 6-contact type Approx. 6.4 W at 0.26 A 4-contact/5-contact type Approx. 4.8 W at 0.2 A Constant: Approx. 2.6 W (average) at 0.2 A (max.)
Insulation Class	Class E (120°C max.)

*A starting current is applied to the solenoid for approx. 10 seconds. After this, the internal circuit switches to constant current.

Indicator

Item	LED Type
Rated voltage	24 VDC
Current consumption	Approx. 10 mA
Color (LED)	Orange

Select models are available for Rapid Delivery.

Visit this product on www.sti.com for details.

Structure (continued)

Operating Cycle Examples for Standard Models

D4SL-N□□□A-□ (Mechanical Lock Models)

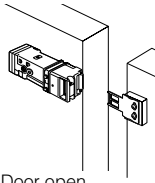
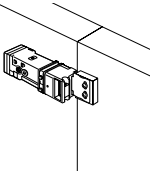
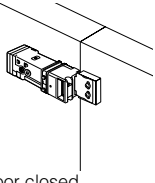
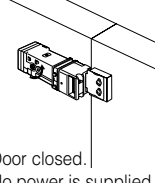
		Condition 1	Condition 2	Condition 3	Turning the special release key
					
		Door open. The door will lock when the door closes.	Door closed. The door is locked.	Door closed. The door can be opened.	Door closed. No power is supplied to the solenoid. The door is unlocked manually.
Terminal No. and Contact No.	Function				
[9]E1-[10]E2	Solenoid ON				
[2]42-[1]11 (NC) [4]52-[3]21 (NC)	Door open/ closed detection and lock monitor contacts				
[3]21-[4]22 (NC) [5]31-[6]32 (NC)	Door open/ closed detection contact				
[5]33-[6]34 (NO)	Door open/ closed detection contact				
[1]41-[2]42 (NC) [7]61-[8]62 (NC)	Lock monitor contact				
[7]63-[8]64 (NO)	Lock monitor contact				

D4SL-N□□□G-□ (Solenoid Lock Models)

		Even when the door is closed, it does not lock until power is supplied to the solenoid.	Door closed. The door is locked.	Door closed. The door can be opened.	<p>The shaded areas indicate the contact is closed and power is supplied to the solenoid.</p> <p>Door open/closed detection and lock monitor contacts: Can be used in safety circuits because of the direct opening mechanisms.</p> <p>Door open/closed detection contact: Can be used to confirm whether the key is inserted and to monitor the open/closed status of a door.</p> <p>Lock monitor contact: Can be used to confirm whether power is supplied to the solenoid and to monitor whether or not a door can be opened or closed.</p>
Terminal No. and Contact No.	Function				
[9]E1-[10]E2	Solenoid ON				
[2]42-[1]11 (NC) [4]52-[3]21 (NC)	Door open/ closed detection and lock monitor contacts				
[3]21-[4]22 (NC) [5]31-[6]32 (NC)	Door open/ closed detection contact				
[5]33-[6]34 (NO)	Door open/ closed detection contact				
[1]41-[2]42 (NC) [7]61-[8]62 (NC)	Lock monitor contact				
[7]63-[8]64 (NO)	Lock monitor contact				

Note: The door open/closed detection and lock monitor contact configuration depends on the model.

Caution: For solenoid-to-lock 6-contact models (contact configuration: N,P,Q,R), if a current is detected in the solenoid before the door is closed, the door might remain unlocked. Apply power to the solenoid AFTER the door is closed to ensure proper locking function.



Select models are available for Rapid Delivery.

Visit this product on www.sti.com for details.

Applicable Door Switches

D4SL-NSK10-LK



G

D4SL-NSK10-LKH

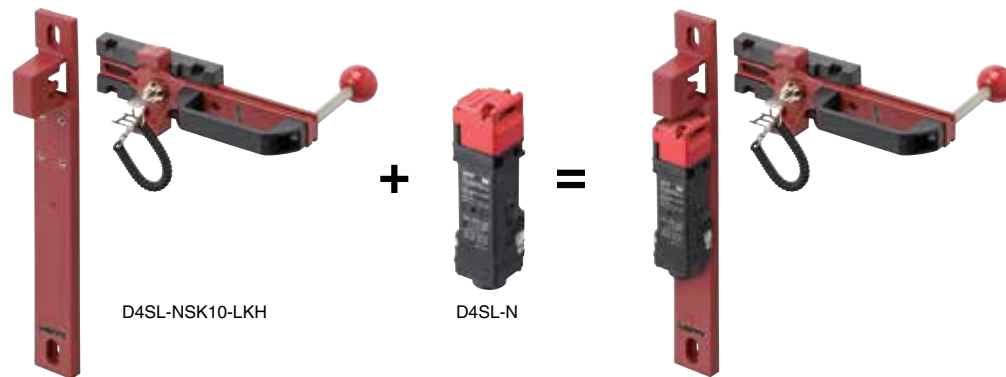

 Select models are available for Rapid Delivery.

Visit this product on www.sti.com for details.

Door Switch Features

The **lockout key** prevents workers from becoming trapped without using a padlock.

Note: Using LEDs of D4SL-N enables confirming whether the door is open or closed and locked or unlocked.

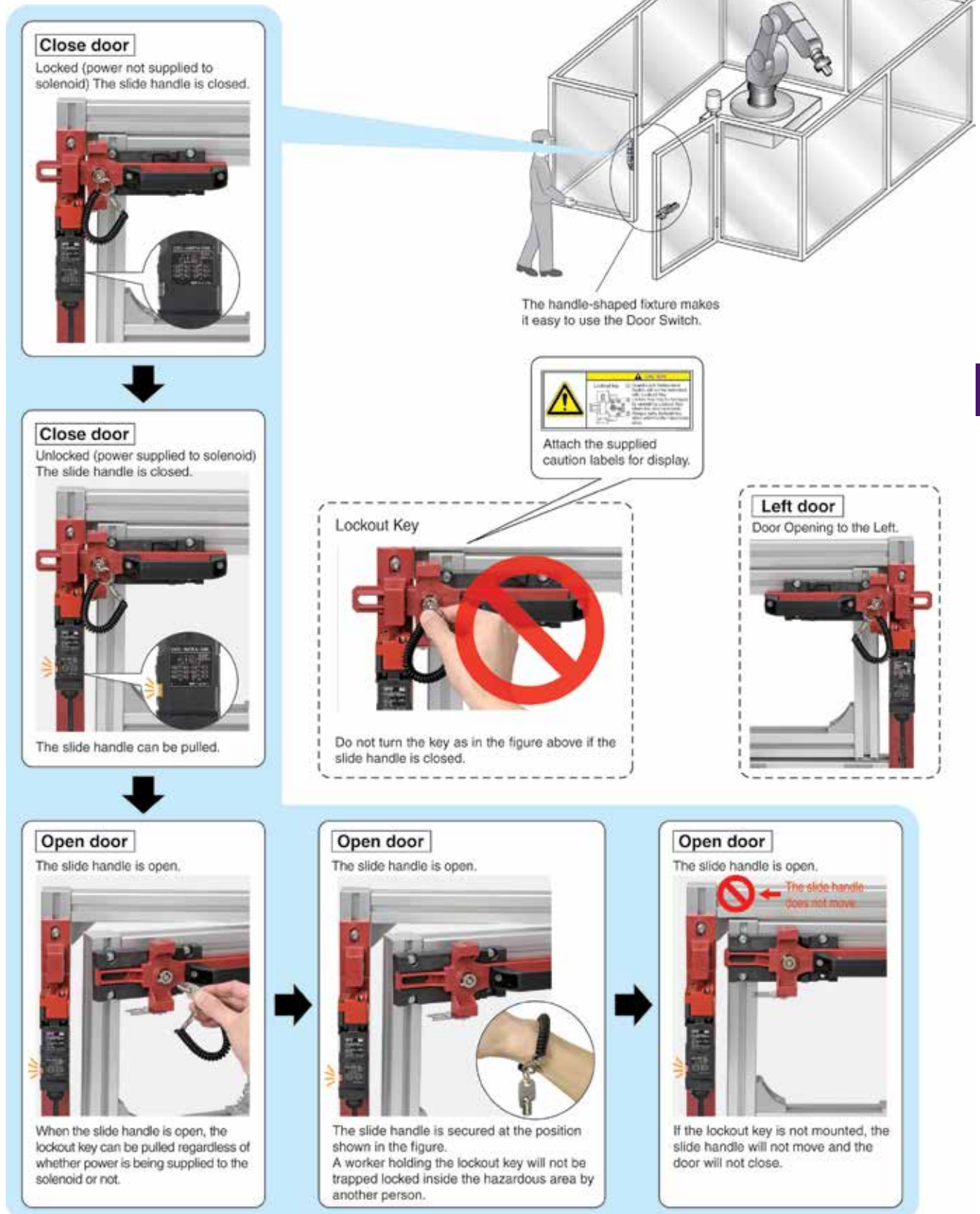

G

Connections (continued)

Contact Form

Indicates conditions where the Key is inserted and the lock is applied.

Model	Contact (door open/ closed detection and lock monitor)	Contact form		Operating pattern	Remarks
		Lock monitor	Door open/ closed detection		
D4SL-N□A□□□□□	1NC/1NO+ 1NC/1NO				Only NC contact 11-12 has a certified direct opening mechanism. (→) The terminals 42-11, 34-33, and 64-63 can be used as unlike poles.
D4SL-N□B□□□□□	1NC/1NO+2NC				Only NC contact 11-12 has a certified direct opening mechanism. (→) The terminals 42-11, 34-33, and 62-61 can be used as unlike poles.
D4SL-N□C□□□□□	2NC+1NC/1NO				Only NC contact 11-12 and 31-32 have a certified direct opening mechanism. (→) The terminals 42-11, 32-31, and 64-63 can be used as unlike poles.
D4SL-N□D□□□□□	2NC+2NC				Only NC contact 11-12 and 31-32 have a certified direct opening mechanism. (→) The terminals 42-11, 32-31, and 62-61 can be used as unlike poles.
D4SL-N□S□□□□□	1NC/1NO+ 1NC/1NO				Only NC contact 21-22 has a certified direct opening mechanism. (→) The terminals 42-41, 22-21, 34-33, and 64-63 can be used as unlike poles.
D4SL-N□T□□□□□	1NC/1NO+2NC				Only NC contact 21-22 has a certified direct opening mechanism. (→) The terminals 42-41, 22-21, 34-33, and 62-61 can be used as unlike poles.
D4SL-N□U□□□□□	2NC+1NC/1NO				Only NC contact 21-22, and 31-32 have a certified direct opening mechanism. (→) The terminals 42-41, 22-21, 32-31, and 64-63 can be used as unlike poles.
D4SL-N□V□□□□□	2NC+2NC				Only NC contact 21-22, and 31-32 have a certified direct opening mechanism. (→) The terminals 42-41, 22-21, 32-31, and 62-61 can be used as unlike poles.

G

Connections (continued)

Contact Form (continued)

Indicates conditions where the Key is inserted and the lock is applied.

Model	Contact (door open/ closed detection and lock monitor)	Contact form		Operating pattern	Remarks
		Lock monitor	Door open/ closed detection		
D4SL-N□E□□-□	2NC/1NO+ 1NC/1NO				Only NC contact 11-12 and 21-22 has a certified direct opening mechanism. (→) The terminals 42-11, 22-21, 34-33, and 64-63 can be used as unlike poles.
D4SL-N□F□□-□	2NC/1NO+2NC				Only NC contact 11-12 and 21-22 has a certified direct opening mechanism. (→) The terminals 42-11, 22-21, 34-33, and 62-61 can be used as unlike poles.
D4SL-N□G□□-□	3NC+1NC/1NO				Only NC contact 11-12, 21-22, and 31-32 has a certified direct opening mechanism. (→) The terminals 42-11, 22-21, 32-31, and 64-63 can be used as unlike poles.
D4SL-N□H□□-□	3NC+2NC				Only NC contact 11-12, 21-22, and 31-32 has a certified direct opening mechanism. (→) The terminals 42-11, 22-21, 32-31, and 62-61 can be used as unlike poles.
D4SL-N□□□□-□	2NC/1NO+ 2NC/1NO				Only NC contact 11-12 and 21-22 has a certified direct opening mechanism. (→) The terminals 42-11, 52-21, 34-33, and 62-61 can be used as unlike poles.
D4SL-N□P□□-□	2NC/1NO+3NC				Only NC contact 11-12 and 21-22 has a certified direct opening mechanism. (→) The terminals 42-11, 52-21, 34-33, and 62-61 can be used as unlike poles.
D4SL-N□Q□□-□	3NC+2NC/1NO				Only NC contact 11-21, 21-22, and 31-32 have a certified direct opening mechanism. (→) The terminals 42-11, 52-21, 32-31, and 64-63 can be used as unlike poles.
D4SL-N□R□□-□	3NC+3NC				Only NC contact 11-12, 21-22, and 31-32 have a certified direct opening mechanism. (→) The terminals 42-11, 52-21, 32-31, and 62-61 can be used as unlike poles.

(mm)

Dimensions and Operating Characteristics

Switches

D4SL-N□□□□-□N (Connector Type)

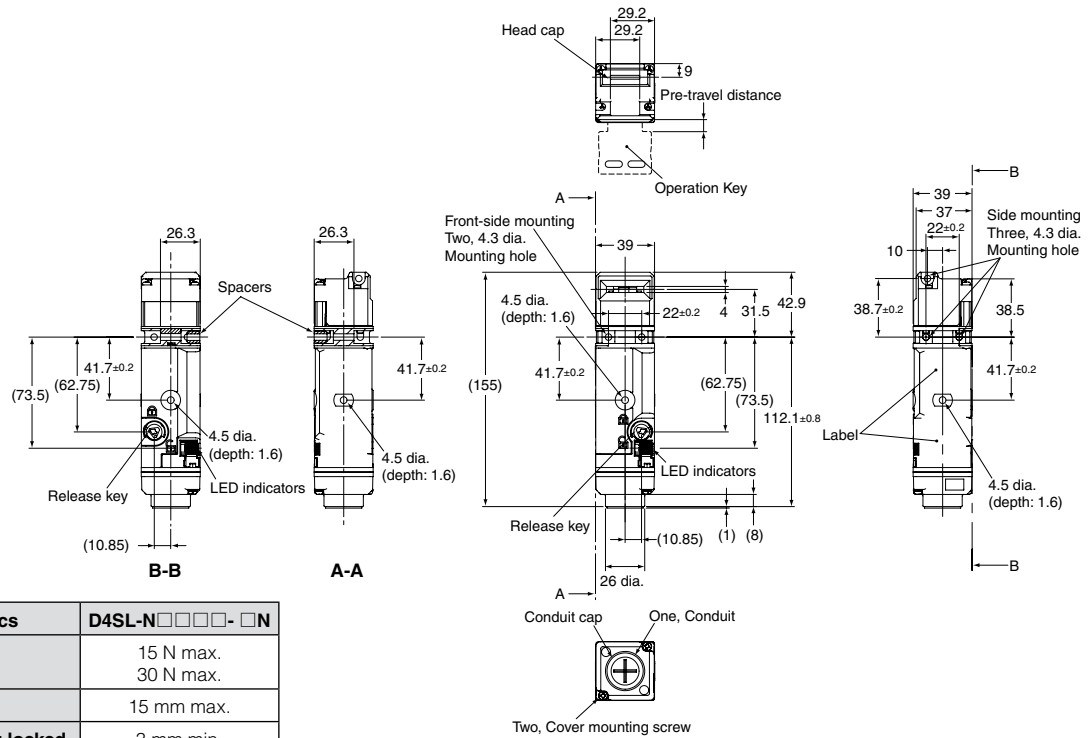

Operating characteristics	D4SL-N□□□□-□N
Key insertion force	15 N max.
Key extraction force	30 N max.
Pre-travel distance	15 mm max.
Movement before being locked	3 mm min.

D4SL-N□□□□-□ (Terminal Block Type)

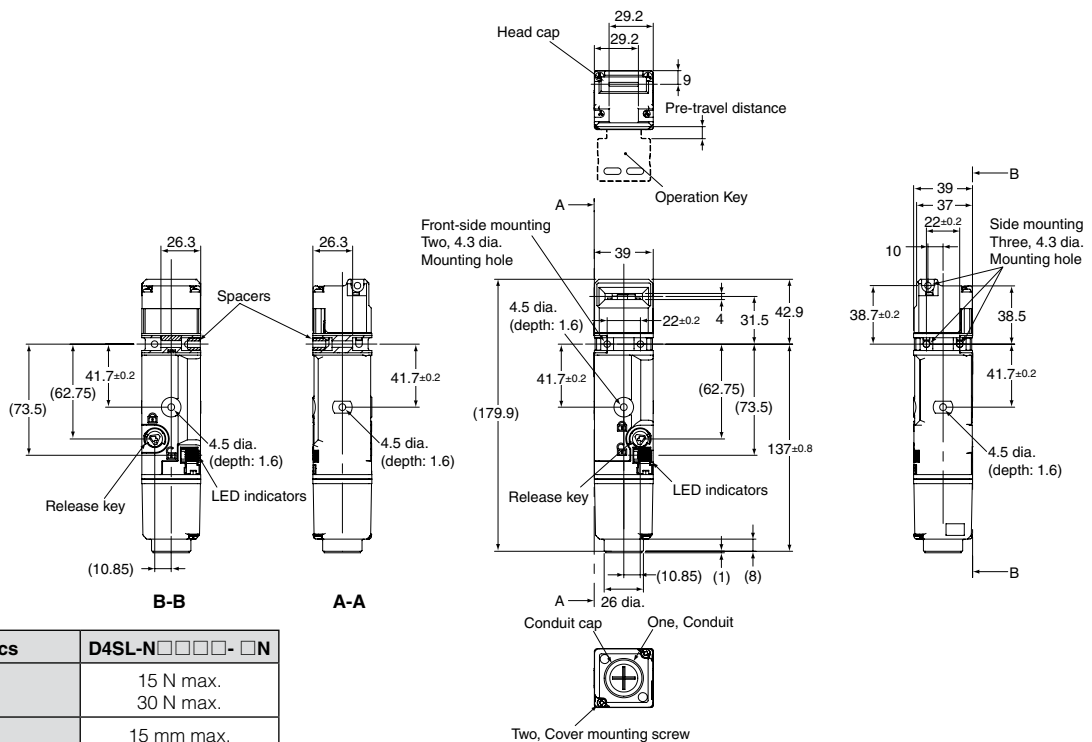

Operating characteristics	D4SL-N□□□□-□N
Key insertion force	15 N max.
Key extraction force	30 N max.
Pre-travel distance	15 mm max.
Movement before being locked	3 mm min.

Unless otherwise specified, a tolerance of ± 0.4 mm applies to all dimensions.

Dimensions and Operating Characteristics (continued)

(mm)

Operation Keys

D4SL-NK1

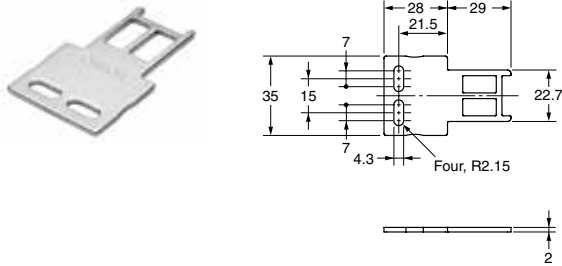

D4SL-NK1S

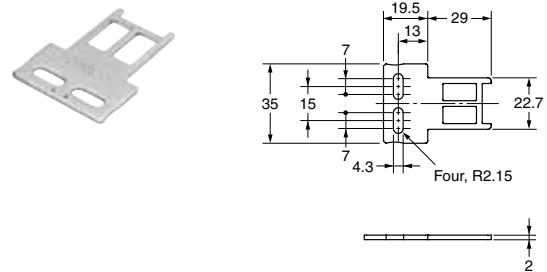

D4SL-NK1G

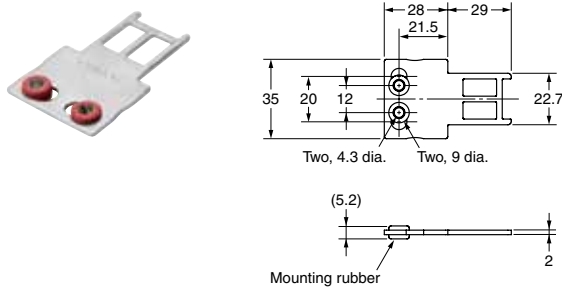

D4SL-NK2

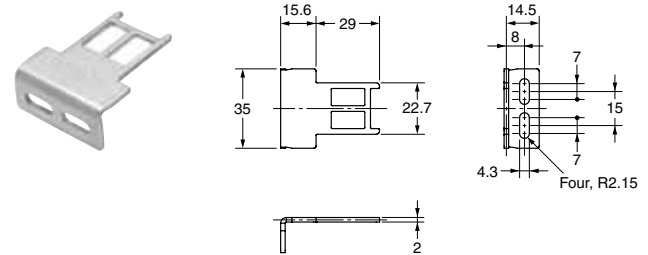

D4SL-NK2G

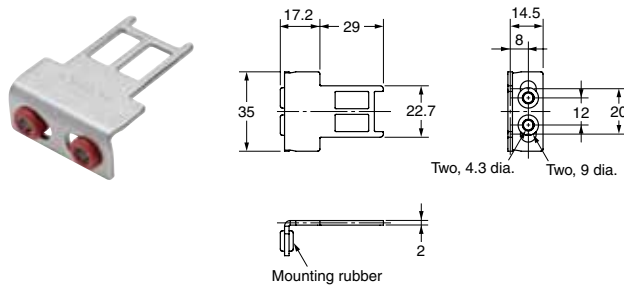

D4SL-NK3

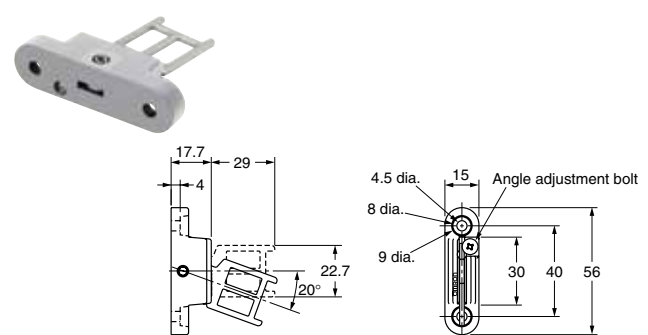

Connector Cable

D4SL-CN□

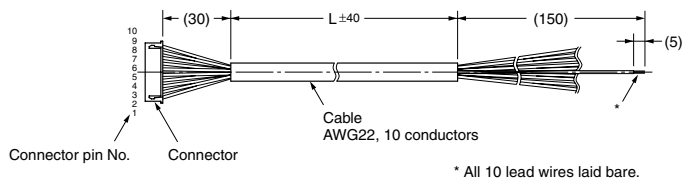

Model	L size
D4SL-CN1	1 m
D4SL-CN3	3 m
D4SL-CN5	5 m

Connector No.	Lead wire color
1	Black
2	Black/White
3	Red
4	Red/White
6	Green

Connector No.	Lead wire color
6	Green/White
7	Yellow
8	Yellow/White
9	Brown
10	Brown White

Unless otherwise specified, a tolerance of ± 0.4 mm applies to all dimensions.

M20-NPT Adapter

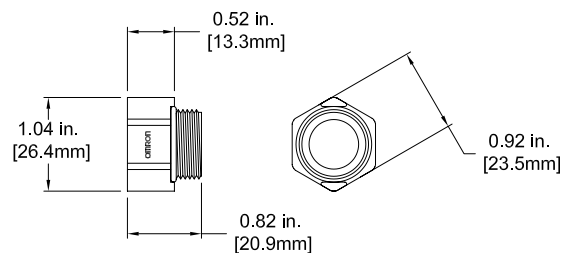

(mm)

Dimensions and Operating Characteristics

Slide Key

D4SL-NSK10-LK

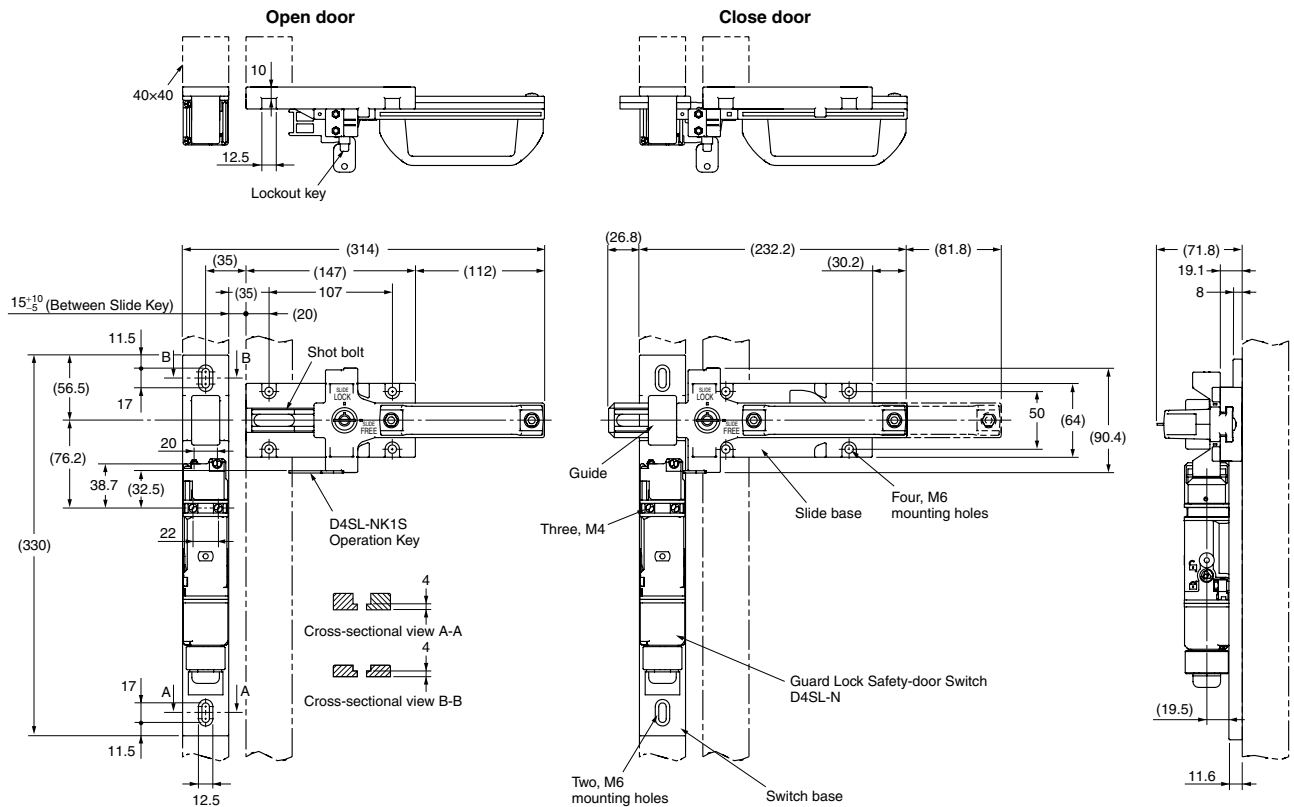

D4SL-NSK10-LKH

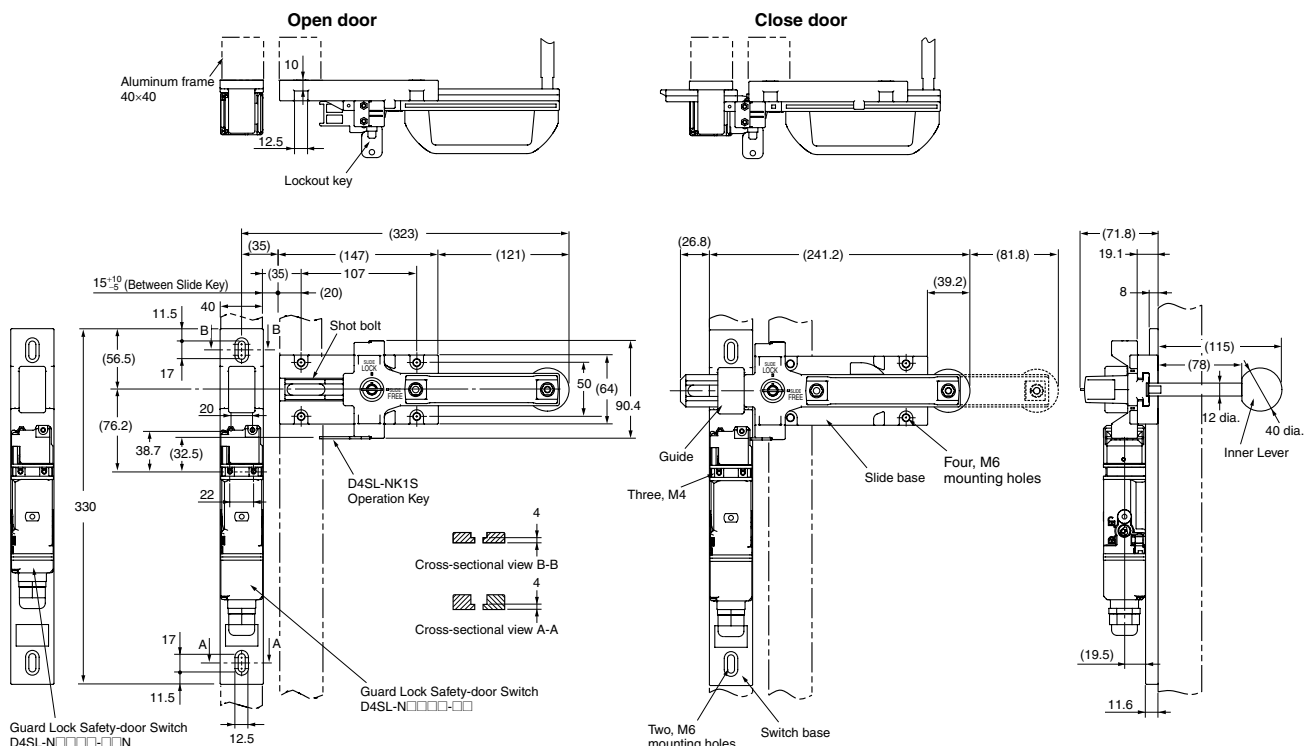

Dimensions and Operating Characteristics (continued)

(mm)

Operating Key Mounting

D4SL-N+D4SL-NK1

With Front-inserted Operation Key

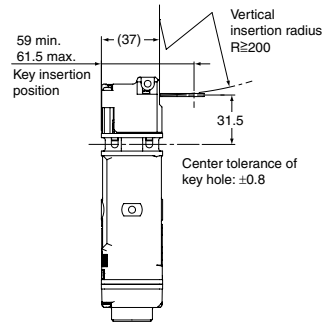
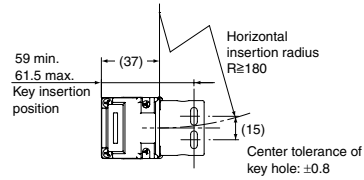

With Top-Inserted Operation Key

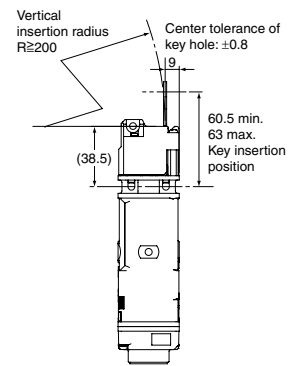
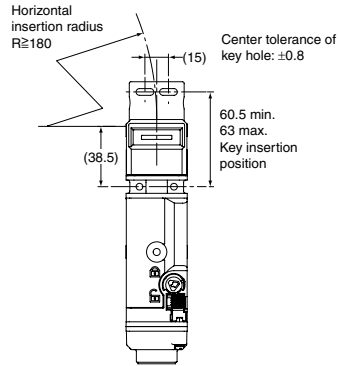

D4SL-N+D4SL-NK1S

With Front-inserted Operation Key

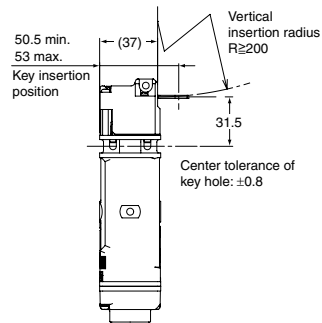
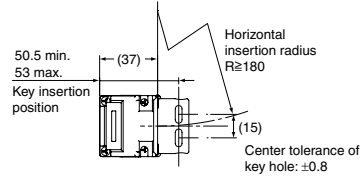

With Top-Inserted Operation Key

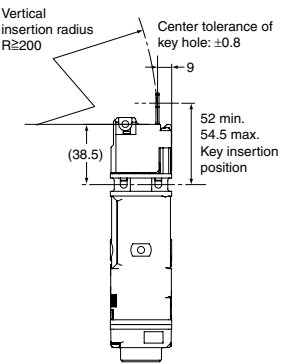
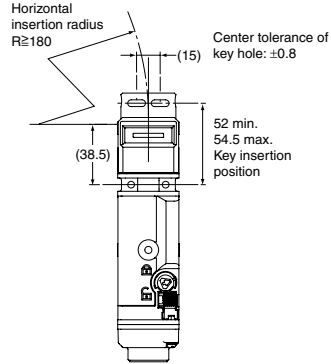

D4SL-N+D4SL-NK1G

With Front-inserted Operation Key

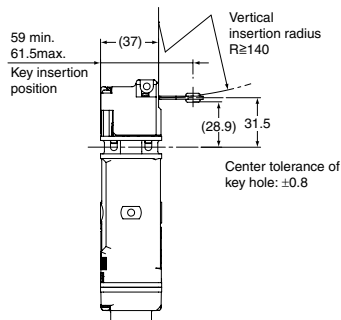
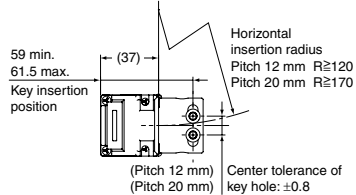

With Top-Inserted Operation Key

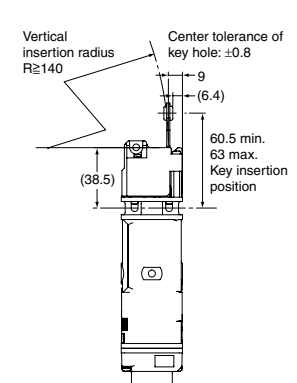
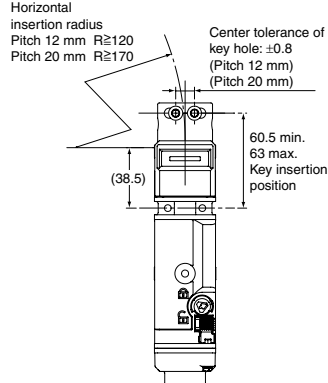

Dimensions and Operating Characteristics (continued)

(mm)

Operating Key Mounting (continued)

D4SL-N+D4SL-NK2



With Front-inserted Operation Key

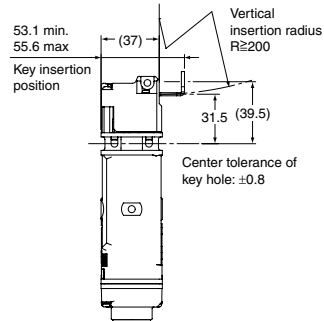
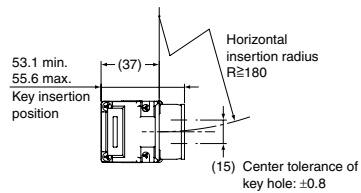

With Top-Inserted Operation Key

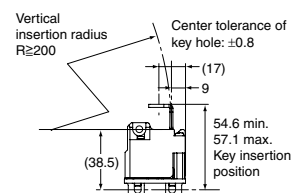
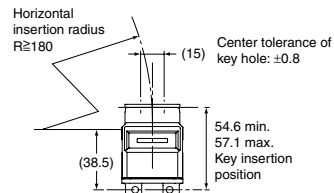

D4SL-N+D4SL-NK2G



With Front-inserted Operation Key

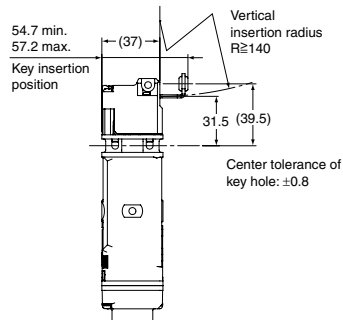
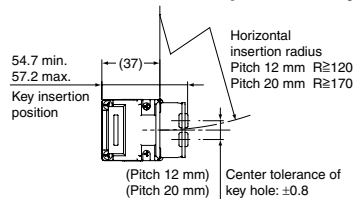

With Top-Inserted Operation Key

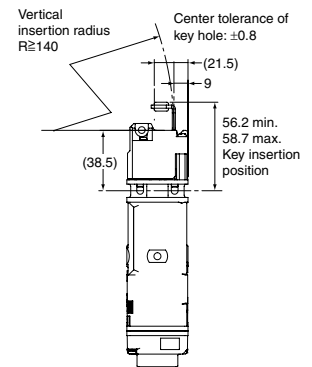
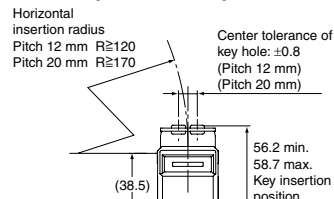

D4SL-N+D4SL-NK3



With Front-inserted Operation Key

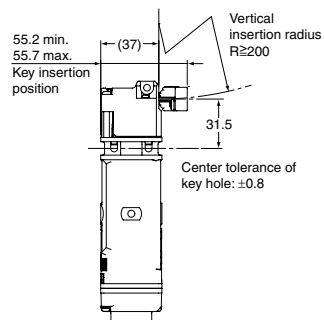
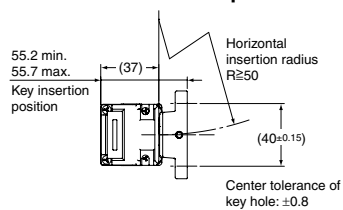

With Top-Inserted Operation Key

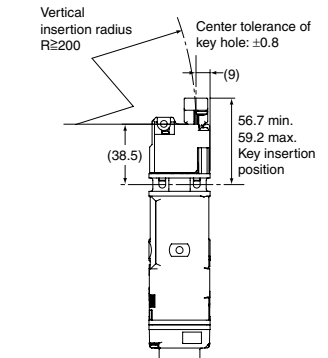
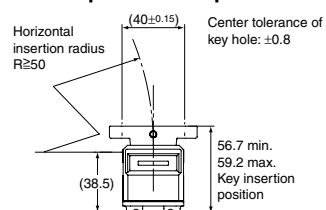

Application Examples

D4SL-N Application Example

PL/Safety Category	Applied models	Stop category	Reset method
Equivalent to PLe/4	D4SL-N□R□A-□ Compact Safety Door Switch with Magnetic Lock (mechanical lock) G9SA-301 (24 VAC/DC) Safety Relay Unit	0	Manual

Application Overview

- If the guard is opened, it is detected with S2 and the power supply to the motor (M) is shut OFF.
- When the guard is closed, the lock status can be detected and the power supply to the motor (M) remains shut OFF until limit switch S3 is pressed.

S1: Safety Limit Switch with direct opening mechanism
(D4B-N, D4N, D4F) (→)

S2: D4SL-N

S3: Reset switch

S4: Lock release switch

KM1 and KM2: Magnetic Contactor

M: 3-phase motor

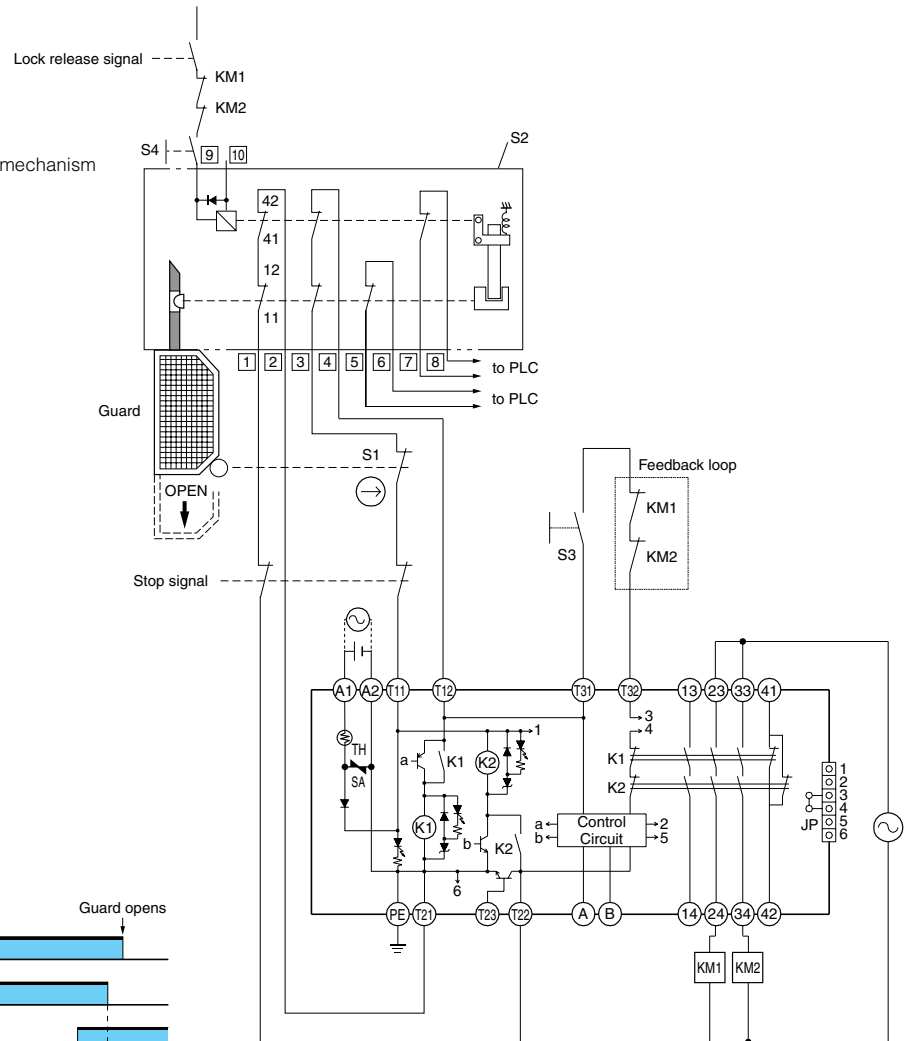

Timing Chart

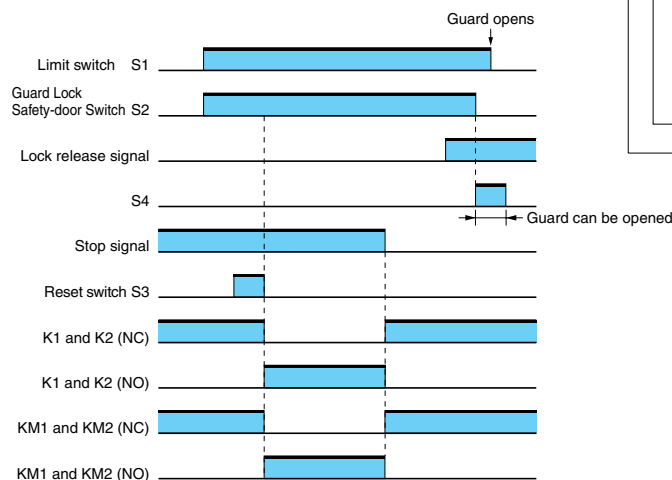

- Notes:
- The above circuit diagram is for Category 3.
 - Numbers inside the boxes are terminal numbers printed on the product.

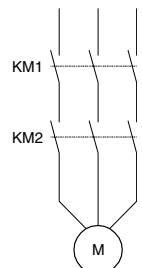

Ordering

Model Number Structure

Switch

D4SL – N ☐ ☐ ☐ ☐ – ☐ ☐ ☐ ☐

1 2 3 4 5 6 7

- 1** Conduit Size
 - 2: G1/2 (conduit)
 - 3: 1/2-14 NPT (M20, includes M20-to-1/2-14NPT conversion adapter)
 - 4: M20
- 2** Built-in Switch

4-contact Model: Door monitor and lock monitors are connected in series internally

A: 1NC/1NO + 1NC/1NO
 B: 1NC/1NO + 2NC
 C: 2NC + 1NC/1NO
 D: 2NC + 2NC

4-contact Model: Door monitor and lock monitors are NOT connected in series internally

S: 1NC/1NO + 1NC/1NO
 T: 1NC/1NO + 2NC
 U: 2NC + 1NC/1NO
 V: 2NC + 2NC

5-contact Model

E: 2NC/1NO + 1NC/1NO
 F: 2NC/1NO + 2NC
 G: 3NC + 1NC/1NO
 H: 3NC + 2NC

6-contact Model

N: 2NC/1NO + 2NC/1NO
 P: 2NC/1NO + 3NC
 Q: 3NC + 2NC/1NO
 R: 3NC + 3NC
- 3** Head Material

4-contact Model

F: Resin

5- or 6-contact Model (common)

F: Resin
 D: Metal
- 4** Door Lock and Release

A: Mechanical lock/24 VDC solenoid release
 G: 24 VDC solenoid lock/mechanical release
- 5** Indicator

4-contact Model

Blank: None

5- or 6-contact Model (common)

D: 24 VDC (orange LED indicator)
- 6** Release Key Type

4-contact Model

Blank: Standard release key (metal)

5- or 6-contact Model (common)

Blank: Special release key (metal)
 4: Special release key (resin) (Note: Release keys are provided)
- 7** Connection Method

Blank: Terminal block
 N: Connector *1

Operation Key

D4SL-NK ☐ ☐

1 2

- 1** Operation Key Type
 - 1: Horizontal mounting
 - 2: Vertical mounting
 - 3: Adjustable mounting (horizontal)
- 1** Key Type

Blank: No cushion rubber
 G: Cushion rubber
 S: No cushion rubber, short type

G

Note:

*1. Connector cables are not included with the connector type and are to be purchased separately.

Caution! For solenoid-to-lock 6-contact models (contact configuration: N,P,Q,R), if a current is detected in the solenoid before the door is closed, the door might remain unlocked. Apply power to the solenoid AFTER the door is closed to ensure proper locking function.

 **Select models are available for Rapid Delivery.**

Visit this product on www.sti.com for details.

Ordering (continued)

List of Models

Release Key Type	Wiring method	Solenoid voltage/ Indicator	Lock and release type	Contact configuration (door open/closed detection switch and lock monitor switch contacts)	Conduit size (See Note.)	Model		
<div>Standard (metal)</div> <div></div>	Connector	24 VDC (Orange)	Mechanical lock Solenoid release	6-contact Model Insert the built-in switch (N, P, Q or R) into the blank □.	G1/2	D4SL-N2□FA-DN		
					1/2-14NPT	D4SL-N3□FA-DN		
					1/2-14NPT	D4SL-N3NFA-DN		
					M20	D4SL-N4□FA-DN		
				5-contact Model Insert the built-in switch (E, F, G or H) into the blank □.	G1/2	D4SL-N2□FA-DN		
					1/2-14NPT	D4SL-N3□FA-DN		
		M20			D4SL-N4□FA-DN			
		4-contact Model Insert the built-in switch (A, B, C, D, S, T, U or V) into the blank □.			G1/2	D4SL-N2□FA-N		
				1/2-14NPT	D4SL-N3□FA-N			
				M20	D4SL-N4□FA-N			
				Terminal block	24 VDC (Orange)	6-contact Model Insert the built-in switch (N, P, Q or R) into the blank □.	G1/2	D4SL-N2□FA-D
		1/2-14NPT					D4SL-N3□FA-D	
	1/2-14NPT	D4SL-N3NFA-D						
	1/2-14NPT	D4SL-N3QFA-D						
	M20	D4SL-N4□FA-D						
	5-contact Model Insert the built-in switch (E, F, G or H) into the blank □.	G1/2				D4SL-N2□FA-D		
		1/2-14NPT			D4SL-N3□FA-D			
		M20			D4SL-N4□FA-D			
		24 VDC (without indicator)			4-contact Model Insert the built-in switch (A, B, C, D, S, T, U or V) into the blank □.	G1/2	D4SL-N2□FA	
	1/2-14NPT					D4SL-N3□FA		
	M20					D4SL-N4□FA		
	Connector					24 VDC (Orange)	Solenoid lock Mechanical release	6-contact Model Insert the built-in switch (N, P, Q or R) into the blank □.
				1/2-14NPT	D4SL-N3□FG-DN			
				1/2-14NPT	D4SL-N3NFG-DN			
		M20	D4SL-N4□FG-DN					
		5-contact Model Insert the built-in switch (E, F, G or H) into the blank □.	G1/2	D4SL-N2□FG-DN				
			1/2-14NPT	D4SL-N3□FG-DN				
			1/2-14NPT	D4SL-N3HFG-DN				
			M20	D4SL-N4□FG-DN				
		24 VDC (without indicator)	4-contact Model Insert the built-in switch (A, B, C, D, S, T, U or V) into the blank □.	G1/2	D4SL-N2□FG-N			
				1/2-14NPT	D4SL-N3□FG-N			
				M20	D4SL-N4□FG-N			
				Terminal block	24 VDC (Orange)	6-contact Model Insert the built-in switch (N, P, Q or R) into the blank □.		G1/2
	1/2-14NPT		D4SL-N3□FG-D					
	1/2-14NPT		D4SL-N3NFG-D					
	M20	D4SL-N4□FG-D						
	5-contact Model Insert the built-in switch (E, F, G or H) into the blank □.	G1/2	D4SL-N2□FG-D					
		1/2-14NPT	D4SL-N3□FG-D					
		M20	D4SL-N4□FG-D					
		24 VDC (without indicator)	4-contact Model Insert the built-in switch (A, B, C, D, S, T, U or V) into the blank □.		G1/2	D4SL-N2□FG		
	1/2-14NPT				D4SL-N3□FG			
	M20				D4SL-N4□FG			

Note: The recommended models for equipment and machinery being exported to Europe are those with an M20 conduit sizes, and for North America, the recommended models are those with a 1/2-14NPT conduit sizes.



Select models are available for Rapid Delivery.

Visit this product on www.sti.com for details.

Ordering (continued)

List of Models (continued)

Release Key Type	Wiring method	Solenoid voltage/ Indicator	Lock and release type	Contact configuration (door open/closed detection switch and lock monitor switch contacts)	Conduit size (See Note.)	Model
<div>Special (resin)</div> <div></div>	Connector	24 VDC (Orange)	Mechanical lock Solenoid release	6-contact Model Insert the built-in switch (N, P, Q or R) into the blank □.	G1/2	D4SL-N2□FA-D4N
					1/2-14NPT	D4SL-N3□FA-D4N
					M20	D4SL-N4□FA-D4N
				5-contact Model Insert the built-in switch (E, F, G or H) into the blank □.	G1/2	D4SL-N2□FA-D4N
					1/2-14NPT	D4SL-N3□FA-D4N
					M20	D4SL-N4□FA-D4N
	Terminal block		6-contact Model Insert the built-in switch (N, P, Q or R) into the blank □.	G1/2	D4SL-N2□FA-D4	
				1/2-14NPT	D4SL-N3□FA-D4	
				1/2-14NPT	D4SL-N3NFA-D4	
			M20	D4SL-N4□FA-D4		
			5-contact Model Insert the built-in switch (E, F, G or H) into the blank □.	G1/2	D4SL-N2□FA-D4	
				1/2-14NPT	D4SL-N3□FA-D4	
	M20	D4SL-N4□FA-D4				
	Connector	Solenoid lock Mechanical release	6-contact Model Insert the built-in switch (N, P, Q or R) into the blank □.	G1/2	D4SL-N2□FG-D4N	
				G1/2	D4SL-N2NFG-D4N	
				1/2-14NPT	D4SL-N3□FG-D4N	
				M20	D4SL-N4□FG-D4N	
			5-contact Model Insert the built-in switch (E, F, G or H) into the blank □.	G1/2	D4SL-N2□FG-D4N	
				1/2-14NPT	D4SL-N3□FG-D4N	
				M20	D4SL-N4□FG-D4N	
				6-contact Model Insert the built-in switch (N, P, Q or R) into the blank □.	G1/2	D4SL-N2□FG-D4
			1/2-14NPT		D4SL-N3□FG-D4	
			1/2-14NPT		D4SL-N3NFG-D4	
			M20		D4SL-N4□FG-D4	
			5-contact Model Insert the built-in switch (E, F, G or H) into the blank □.	G1/2	D4SL-N2□FG-D4	
		1/2-14NPT		D4SL-N3□FG-D4		
		M20		D4SL-N4□FG-D4		

Note: The recommended models for equipment and machinery being exported to Europe are those with an M20 conduit sizes, and for North America, the recommended models are those with a 1/2-14NPT conduit sizes.









Select models are available for Rapid Delivery.

Visit this product on www.sti.com for details.

Ordering (continued)

Operation Keys

Type		Model
Horizontal mounting		D4SL-NK1
Horizontal mounting (Short)		D4SL-NK1S
Horizontal mounting (Cushion rubber)		D4SL-NK1G
Vertical mounting		D4SL-NK2

Vertical mounting (Cushion rubber)		D4SL-NK2G
Adjustable (Horizontal)		D4SL-NK3

Notes:

D4SL-NK□□ actuators are compatible with both D4SL & D4SL-N switches



D4SL-K□□ actuators are also compatible with both D4SL & D4SL-N switches

Connector Cables

Type	Model
1 m	D4SL-CN1
3 m	D4SL-CN3
5 m	D4SL-CN5

G

Slide Key

Type	Specifications	Contents	Model	Applicable Door Switch
	Weight: Approx. 0.6 kg Mechanical durability: 20,000 operations min.	Slide Key: 1 (not yet mounted) D4SL-N mounting plate: 1 Door Switch special mounting screws: 3 D4SL-NK1 (operation key): 1 D4SL-NK1 special mounting screws: 2 Lockout keys: 2 Lockout key strap: 1 Caution labels (stickers): 2 sheets (English and Japanese)	D4SL-NSK10-LK	D4SL-N
	Weight: Approx. 0.1 kg	Inner Lever: 1	D4SL-SK10H *	—
	Weight: Approx. 0.7 kg Mechanical durability: 20,000 operations min.	Slide Key: 1 (not yet mounted) Inner Lever: 1 D4SL-N mounting plate: 1 Door Switch special mounting screws: 3 D4SL-NK1 (operation key): 1 D4SL-NK1 special mounting screws: 2 Lockout keys: 2 Lockout key strap: 1 Caution labels (stickers): 2 sheets (English and Japanese)	D4SL-NSK10-LKH	D4SL-N



Select models are available for Rapid Delivery.

Visit this product on www.sti.com for details.